

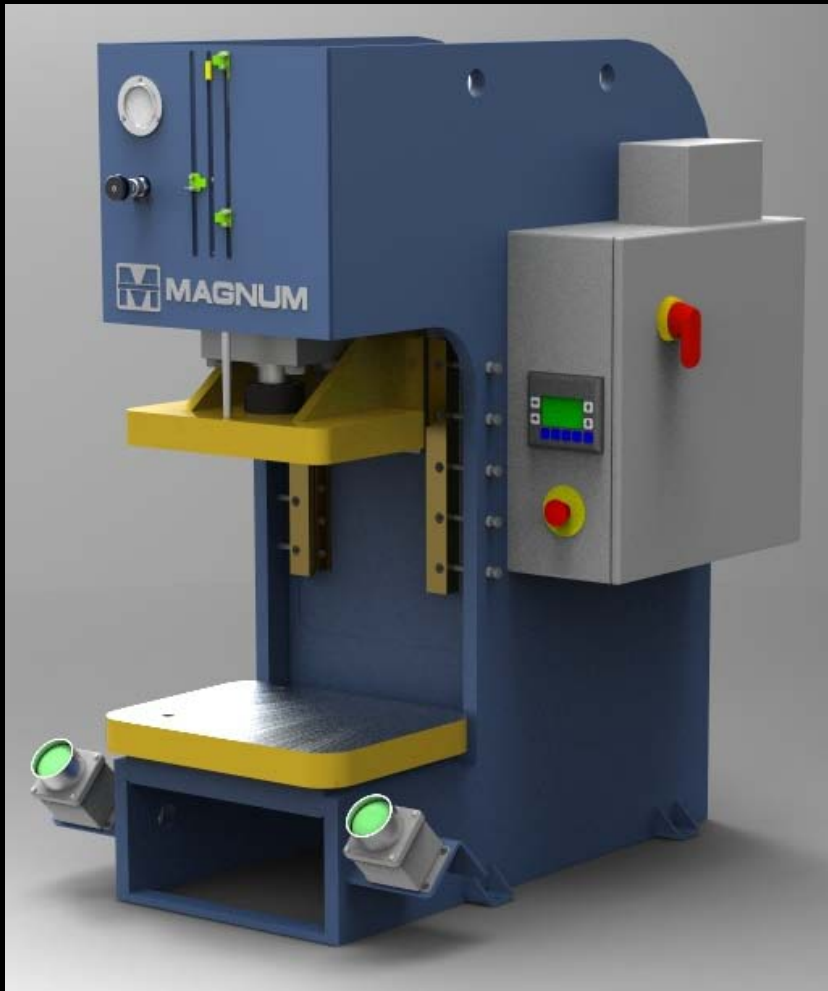

MAGNUM P R E S S

6 Industrial Dr - Jerseyville, IL 62052 - www.magnumpress.com - 618-498-7077 618-498-7022 fax



Standard Equipment:

- Allen Bradley MicroLogix PLC with Panel View HMI based controls
- 2-Hand No-Tie-Down Start
- CAT 4 Safety Start Relay
- Adjustable Tonnage
- Adjustable Stroke
- Pressure and Distance Reversal Mode
- Manual Setup Mode
- Energy Saver Shut Down
- Top Stop Over-Run
- True 2 Speed Ram
- Electro-Hydraulic Decompression
- Self-Contained Removable Hydraulic Power Unit
- Visual Level/Temp Gauge
- Removable Bolster
- Lockable Disconnect
- NEMA enclosures
- TEFC EISA Compliant Electric Motor
- Magnetic Starter/ Electronic Overload
- Single Point Power Connection

Magnum Press has a long list of options that you can select from to customize your press the way you need it.

MGB Series Bench Model Gap Frame Press with Gib Guided Tool Plate

Bench Model Gap Frame Hydraulic Press

Often referred to as a "C" frame hydraulic press, these compact hydraulic presses are available in standard model configurations from 2 ton to 35 tons. These machines can be easily customized for your application. They are designed to be mounted on separate stand or table. These self contained hydraulic presses are suitable for a wide variety of operations including assembly, blanking, coining, forming, punching, riveting and staking. As with any Magnum hydraulic press they can be modified to meet your specific need. They are available in MCB standard gap frame configuration, M2PB 2 post guided tool plate, M4PB 4 post guided tool plate, MGB gib guided and an MCC economical compact version.

Optional Floor Stands:

- FS-01 fits 2-6 Ton Presses
24" wide x 30" deep x 30" high
- FS-02 fits 10-15 Ton Presses
30" wide x 40" deep x 30" high
- FS-03 fits 25-35 Ton Presses
32" wide x 45" deep x 20" high



MAGNUM P R E S S

6 Industrial Dr - Jerseyville, IL 62052 - www.magnumpress.com - 618-498-7077 618-498-7022 fax

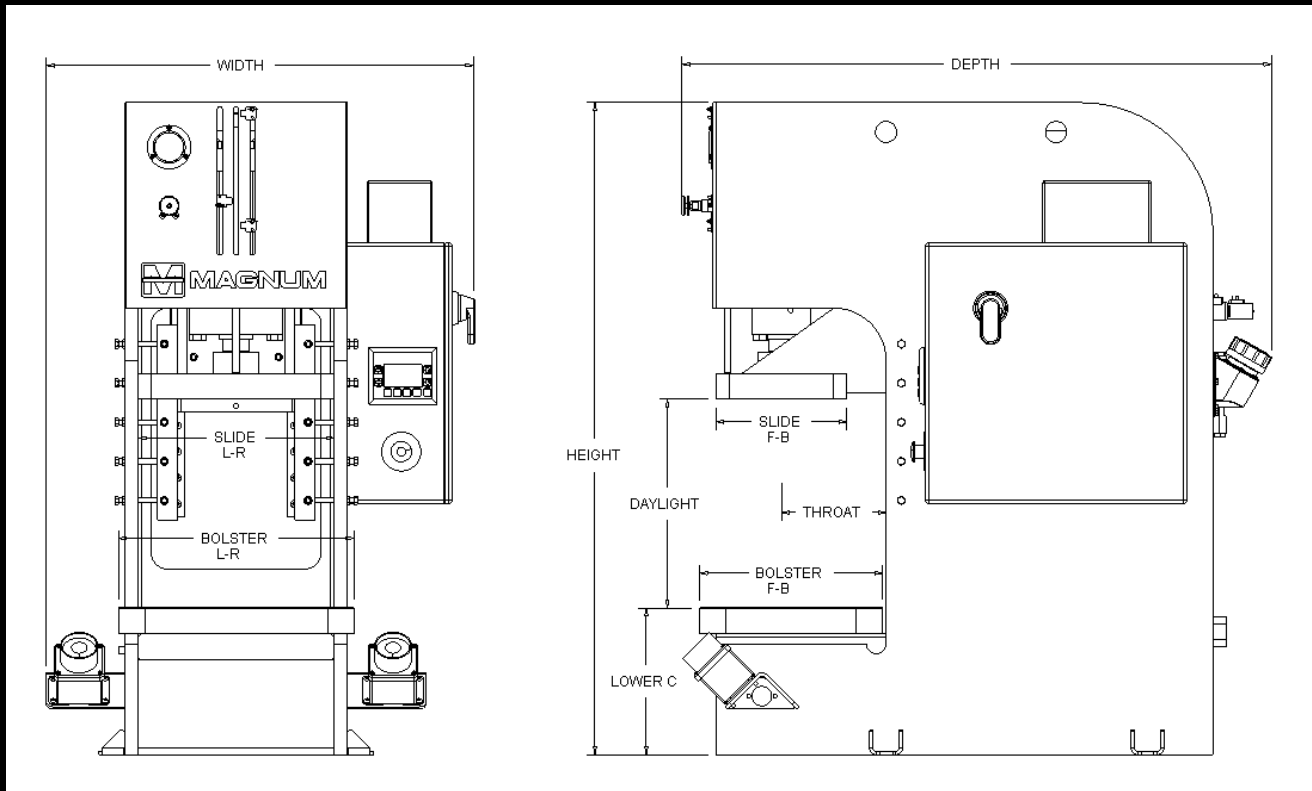

MODEL	MGB-	10A	10B	15A	15B	25A	25B	35A	35B
Rated Tonnage (Adjustable)		10.4	10.4	15.7	15.7	24.5	24.5	35.3	35.3
CPM (1")	.13" WORK	78	78	68	68	70	70	70	70
CPM (4")		31	67	25	61	27	61	26	56
Stroke (in. adjustable)		8	8	8	8	10	10	10	10
Daylight (in)		16	16	16	16	20	20	20	20
Shut Height (in)		8	8	8	8	10	10	10	10
Throat (in)		8	8	8	8	10	10	10	10
Bolster L-R (in)		18	18	19	19	24	24	25	25
Bolster F-B (in)		14	14	14	14	16	16	17.5	17.5
Slide L-R (in)		15	15	15	15	20	20	20	20
Slide F-B (in)		10	10	10	10	10.5	10.5	13	13
Width (in)		33	33	34	34	39	39	39	39
Depth (in)		43	43	43	43	55	55	57	57
Height (in)		50	50	50	50	60	60	62	62
Approx Weight (lbs)		2150	2200	2260	2310	4165	4255	5030	5065
Lower 'C' Height (in)		11.3	11.3	11.3	11.3	14	14	14.5	14.5

Specifications subject to change without notice.