



# MAGNUM P R E S S

PO Box 317 - Adamsville, TN 38310 - [www.magnumpress.com](http://www.magnumpress.com) - 731-632-1285 731-632-1283 fax



### Standard Equipment:

- Allen Bradley MicroLogix PLC with Panel View HMI based controls
- 2-Hand No-Tie-Down Start
- CAT 4 Safety Start Relay
- Adjustable Tonnage
- Adjustable Stroke
- Pressure and Distance Reversal Mode
- Manual Setup Mode
- Energy Saver Shut Down
- Top Stop Over-Run
- True 2 Speed Ram
- Electro-Hydraulic Decompression
- Self-Contained Removable Hydraulic Power Unit
- Visual Level/Temp Gauge
- Removable Bolster
- Lockable Disconnect
- NEMA enclosures
- TEFC EISA Compliant Electric Motor
- Magnetic Starter/ Electronic Overload
- Single Point Power Connection

*Magnum Press has a long list of options that you can select from to customize your press the way you need it.*

## MGB15B 15 Ton High Speed Bench Model Gap Frame Press w/ Gib Guided Tool Plate

### Bench Model Gap Frame Hydraulic Press

Often referred to as a "C" frame hydraulic press, these compact hydraulic presses are available in standard model configurations from 2 ton to 35 tons. These machines can be easily customized for your application. They are designed to be mounted on separate stand or table. These self contained hydraulic presses are suitable for a wide variety of operations including assembly, blanking, coining, forming, punching, riveting and staking. As with any Magnum hydraulic press they can be modified to meet your specific need. They are available in MCB standard gap frame configuration, M2PB 2 post guided tool plate, M4PB 4 post guided tool plate, MGB gib guided and an MCC economical compact version.

### Optional FS-02 Bench



30" High



# MAGNUM PRESS

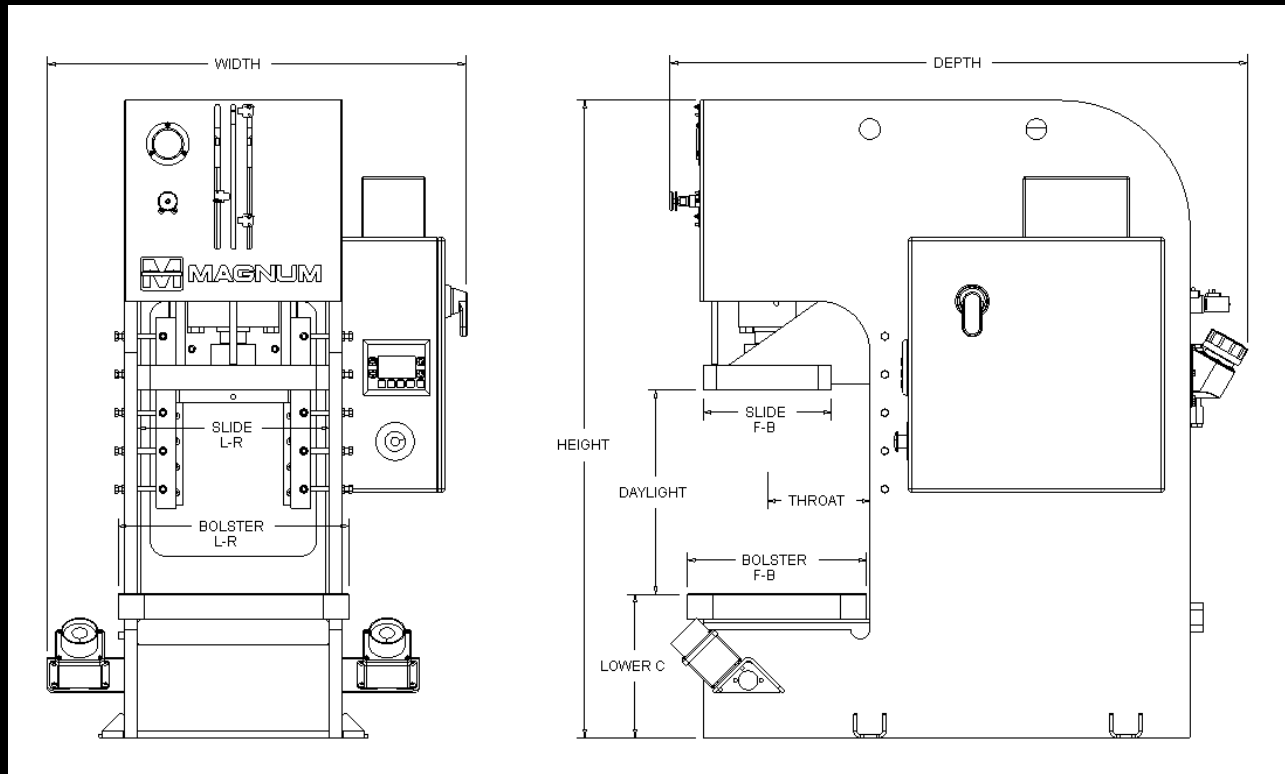

MODEL NUMBER	MGB15B High Speed 15 Ton Gap Frame Press w/ Gib Guided Tool Plate
Adjustable Tonnage (rated)	3.1 tons to 15.7 tons
Daylight	16"
Shut Height	8"
Throat	8"
Bolster Left to Right	19"
Bolster Front to Back	14"
Slide Left to Right	15"
Slide Front to Back	10"
Stroke Length <i>adjustable</i>	1" to 8"
Cycles per Min based on listed total stroke and 0.13" work stroke	
CPM @ 1" stroke	68
CPM @ 2" stroke	87
CPM @ 3" stroke	71
CPM @ 4" stroke	61
CPM @ 6" stroke	47
Reservoir Capacity	25 gallons
Input Voltage <i>specify</i>	230/460 VAC 3PH/60Hz
Approximate Foot Print	34" wide x 43" deep x 50" high
Lower C Height	11.3"
Approximate Weight	2,310 lbs.

Specifications subject to change without notice.