

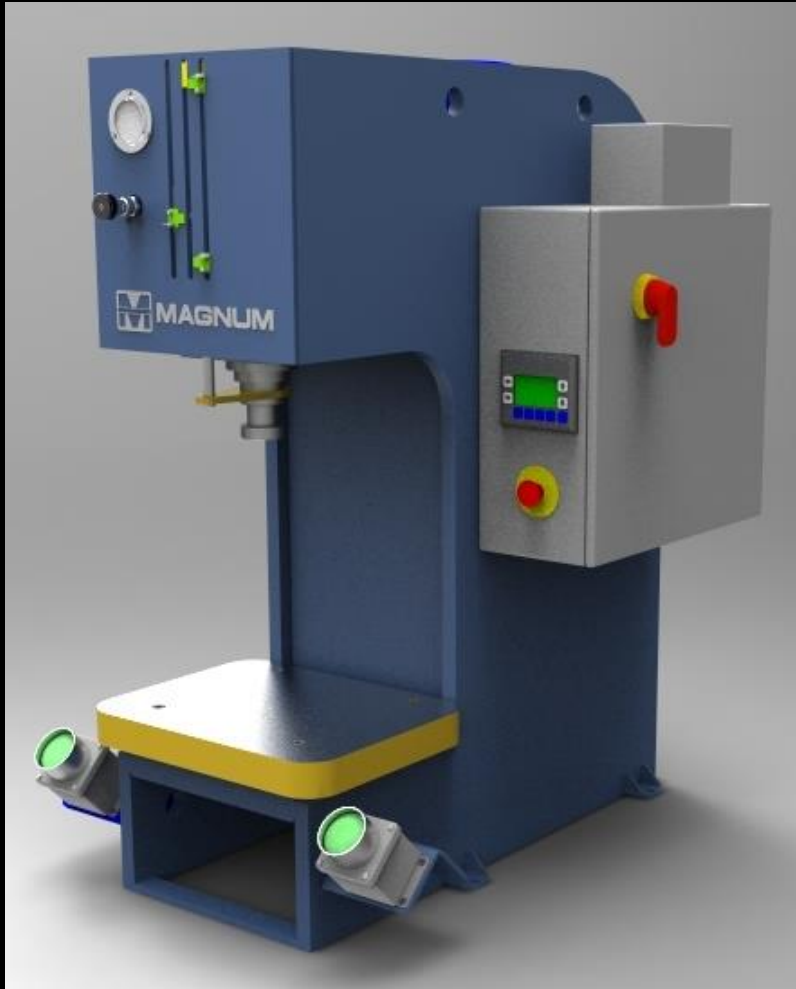

MAGNUM P R E S S

PO Box 317 - Adamsville, TN 38310 - www.magnumpress.com - 731-632-1285 731-632-1283 fax



Standard Equipment:

- Allen Bradley MicroLogix PLC with Panel View HMI based controls
- 2-Hand No-Tie-Down Start
- CAT 4 Safety Start Relay
- Adjustable Tonnage
- Adjustable Stroke
- Pressure and Distance Reversal Mode
- Manual Setup Mode
- Energy Saver Shut Down
- Top Stop Over-Run
- True 2 Speed Ram
- Electro-Hydraulic Decompression
- Self-Contained Removable Hydraulic Power Unit
- Visual Level/Temp Gauge
- Removable Bolster
- Lockable Disconnect
- NEMA enclosures
- TEFC EISA Compliant Electric Motor
- Magnetic Starter/ Electronic Overload
- Single Point Power Connection

Magnum Press has a long list of options that you can select from to customize your press the way you need it.

MCB6B 6 Ton High Speed Bench Model Gap Frame Press

Bench Model Gap Frame Hydraulic Press

Often referred to as a "C" frame hydraulic press, these compact hydraulic presses are available in standard model configurations from 2 ton to 35 tons. These machines can be easily customized for your application. They are designed to be mounted on separate stand or table. These self contained hydraulic presses are suitable for a wide variety of operations including assembly, blanking, coining, forming, punching, riveting and staking. As with any Magnum hydraulic press they can be modified to meet your specific need. They are available in MCB standard gap frame configuration, M2PB 2 post guided tool plate, M4PB 4 post guided tool plate, MGB gib guided and an MCC economical compact version.

Optional FS-01 Bench



30" High



MAGNUM PRESS

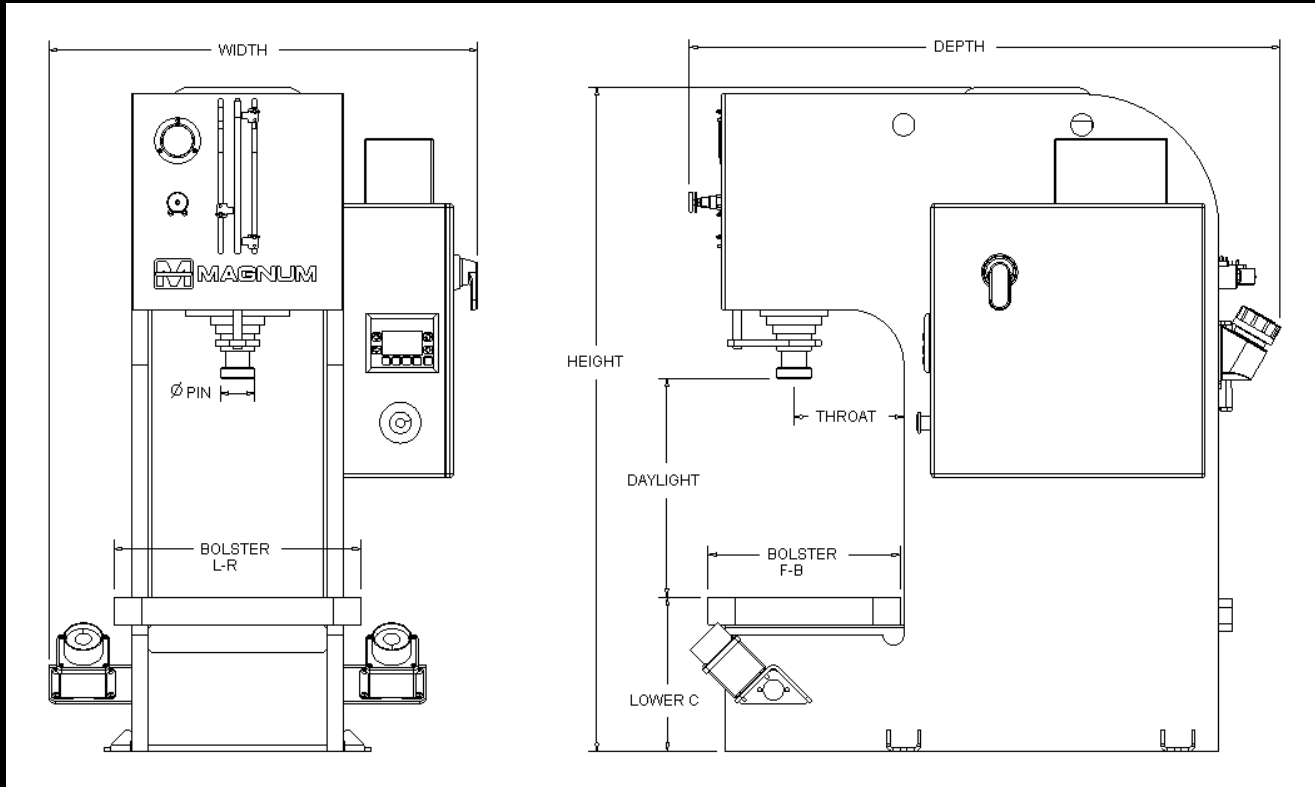

MODEL NUMBER	MCB6B High Speed 6 Ton Gap Frame Press
Adjustable Tonnage (rated)	1.2 tons to 6.1 tons
Daylight	14"
Shut Height	7"
Throat	7"
Bolster Left to Right	13"
Bolster Front to Back	12"
Stroke Length <i>adjustable</i>	1" to 7"
Cycles per Min based on listed total stroke and 0.13" work stroke	
CPM @ 1" stroke	90
CPM @ 2" stroke	115
CPM @ 3" stroke	98
CPM @ 4" stroke	80
CPM @ 6" stroke	67
Reservoir Capacity	10 gallons
Input Voltage <i>specify</i>	230/460 VAC 3PH/60Hz
Approximate Foot Print	27" wide x 42" deep x 40" high
Lower 'C' Height	9"
Approximate Weight	735 lbs.

Specifications subject to change without notice.