

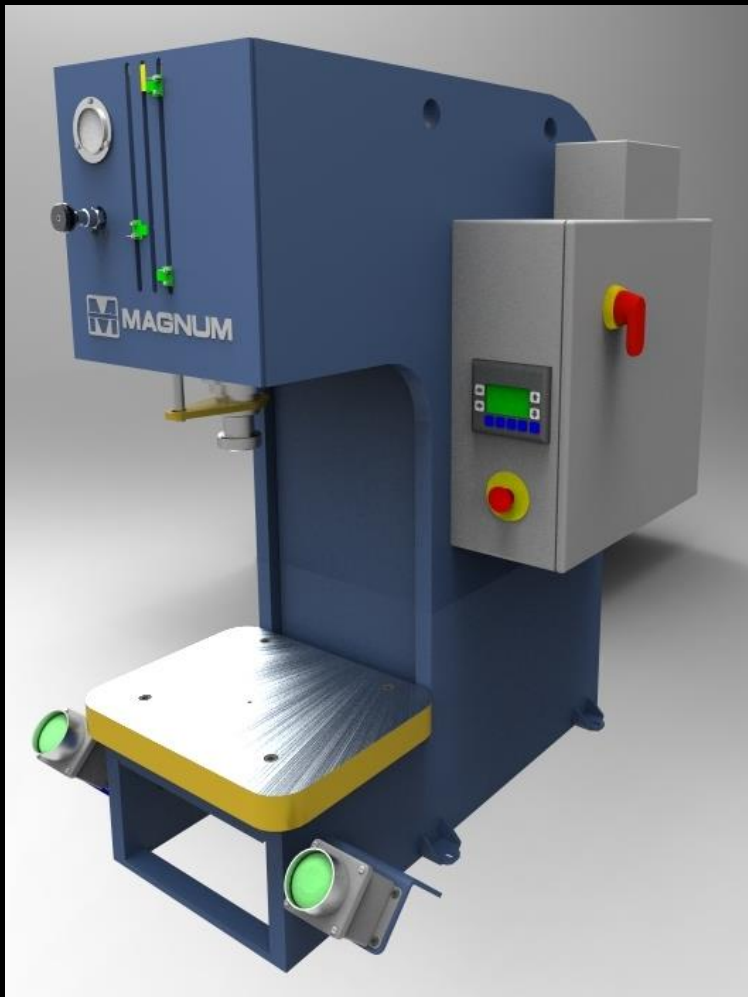

MAGNUM

P R E S S

PO Box 317 - Adamsville, TN 38310 - www.magnumpress.com - 731-632-1285 731-632-1283 fax



Standard Equipment:

- Allen Bradley MicroLogix PLC with Panel View HMI based controls
- 2-Hand No-Tie-Down Start
- CAT 4 Safety Start Relay
- Adjustable Tonnage
- Adjustable Stroke
- Pressure and Distance Reversal Mode
- Manual Setup Mode
- Energy Saver Shut Down
- Top Stop Over-Run
- True 2 Speed Ram
- Electro-Hydraulic Decompression
- Self-Contained Removable Hydraulic Power Unit
- Visual Level/Temp Gauge
- Removable Bolster
- Lockable Disconnect
- NEMA enclosures
- TEFC EISA Compliant Electric Motor
- Magnetic Starter/ Electronic Overload
- Single Point Power Connection

Magnum Press has a long list of options that you can select from to customize your press the way you need it.

MCB35B 35 Ton High Speed

Bench Model Gap Frame Press

Bench Model Gap Frame Hydraulic Press

Often referred to as a "C" frame hydraulic press, these compact hydraulic presses are available in standard model configurations from 2 ton to 35 tons. These machines can be easily customized for your application. They are designed to be mounted on separate stand or table. These self contained hydraulic presses are suitable for a wide variety of operations including assembly, blanking, coining, forming, punching, riveting and staking. As with any Magnum hydraulic press they can be modified to meet your specific need. They are available in MCB standard gap frame configuration, M2PB 2 post guided tool plate, M4PB 4 post guided tool plate, MGB gib guided and an MCC economical compact version.

Optional FS-03 Bench



20" High



MAGNUM PRESS

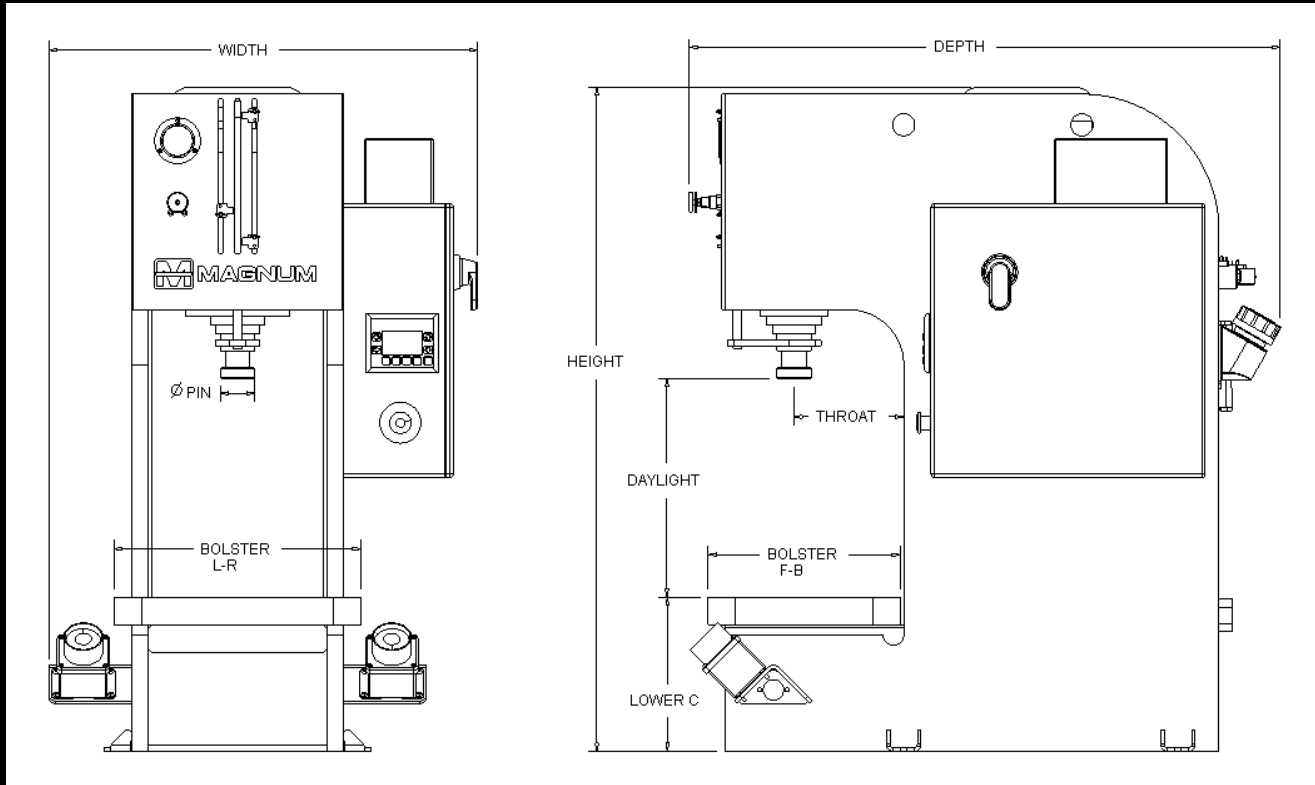

MODEL NUMBER	MCB35B High Speed 35 Ton Gap Frame Press
Adjustable Tonnage (rated)	7.1 tons to 35.3 tons
Daylight	20"
Shut Height	10"
Throat	10"
Bolster Left to Right	23"
Bolster Front to Back	17.5"
Stroke Length <i>adjustable</i>	1" to 10"
Cycles per Min based on listed total stroke and 0.13" work stroke	
CPM @ 1" stroke	70
CPM @ 2" stroke	77
CPM @ 3" stroke	63
CPM @ 4" stroke	56
CPM @ 6" stroke	41
Reservoir Capacity	45 gallons
Input Voltage <i>specify</i>	230/460 VAC 3PH/60Hz
Approximate Foot Print	37" wide x 57" deep x 61" high
Lower 'C' Height	14.5"
Approximate Weight	4,450 lbs.

Specifications subject to change without notice.