

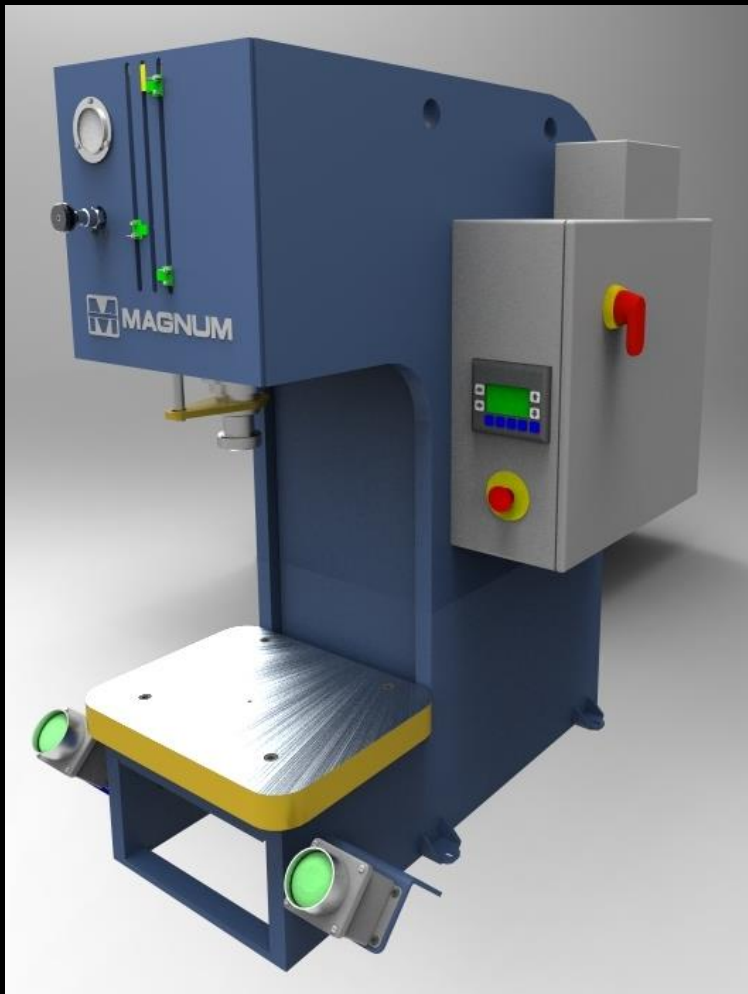

MAGNUM P R E S S

PO Box 317 - Adamsville, TN 38310 - www.magnumpress.com - 731-632-1285 731-632-1283 fax



Standard Equipment:

- Allen Bradley MicroLogix PLC with Panel View HMI based controls
- 2-Hand No-Tie-Down Start
- CAT 4 Safety Start Relay
- Adjustable Tonnage
- Adjustable Stroke
- Pressure and Distance Reversal Mode
- Manual Setup Mode
- Energy Saver Shut Down
- Top Stop Over-Run
- True 2 Speed Ram
- Electro-Hydraulic Decompression
- Self-Contained Removable Hydraulic Power Unit
- Visual Level/Temp Gauge
- Removable Bolster
- Lockable Disconnect
- NEMA enclosures
- TEFC EISA Compliant Electric Motor
- Magnetic Starter/ Electronic Overload
- Single Point Power Connection

Magnum Press has a long list of options that you can select from to customize your press the way you need it.

MCB15A 15 Ton Bench Model Gap Frame Press

Bench Model Gap Frame Hydraulic Press

Often referred to as a "C" frame hydraulic press, these compact hydraulic presses are available in standard model configurations from 2 ton to 35 tons. These machines can be easily customized for your application. They are designed to be mounted on separate stand or table. These self contained hydraulic presses are suitable for a wide variety of operations including assembly, blanking, coining, forming, punching, riveting and staking. As with any Magnum hydraulic press they can be modified to meet your specific need. They are available in MCB standard gap frame configuration, M2PB 2 post guided tool plate, M4PB 4 post guided tool plate, MGB gib guided and an MCC economical compact version.

Optional FS-02 Bench



30" High



MAGNUM PRESS

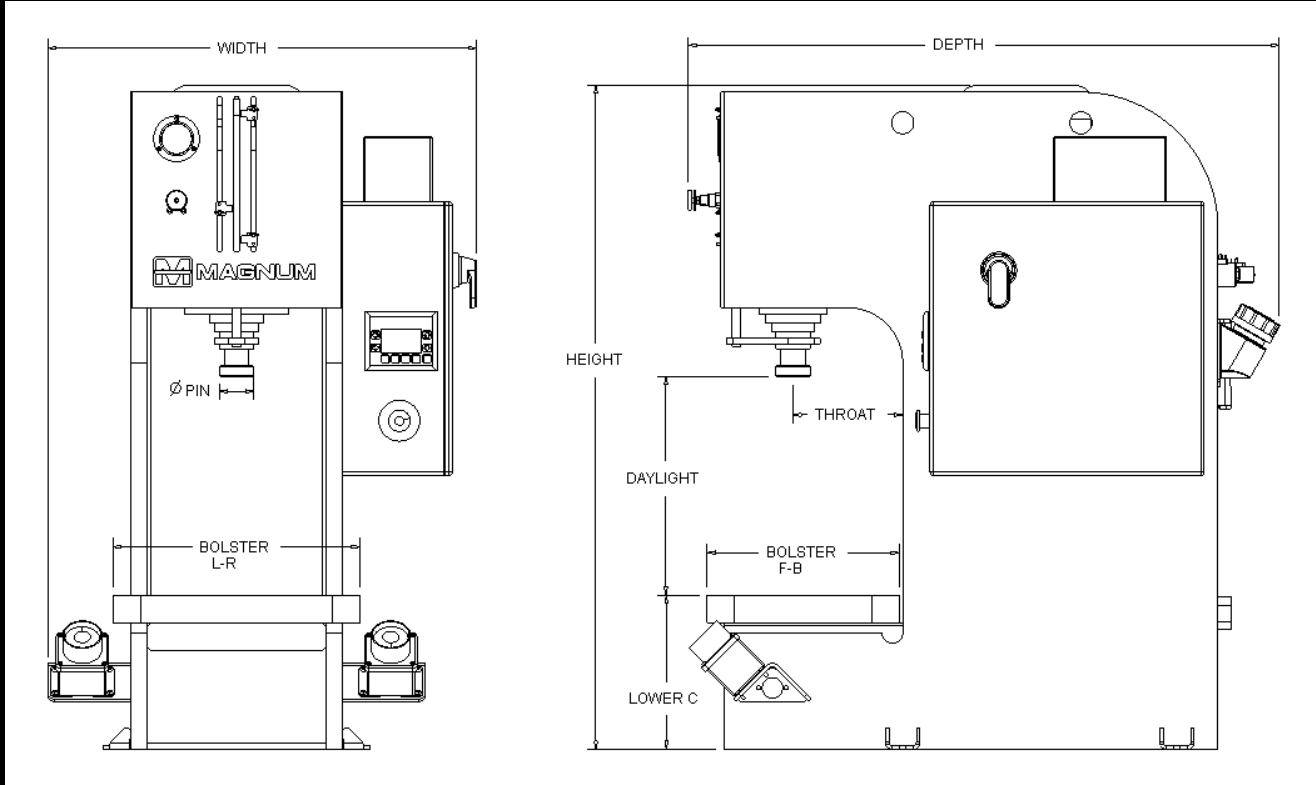

| MODEL NUMBER | MCB15A 15 Ton Gap Frame Press |
|---|--------------------------------|
| Adjustable Tonnage (rated) | 3.1 tons to 15.7 tons |
| Daylight | 16" |
| Shut Height | 8" |
| Throat | 8" |
| Bolster Left to Right | 18" |
| Bolster Front to Back | 14" |
| Stroke Length <i>adjustable</i> | 1" to 8" |
| Cycles per Min based on listed total stroke and 0.13" work stroke | |
| CPM @ 1" stroke | 68 |
| CPM @ 2" stroke | 44 |
| CPM @ 3" stroke | 32 |
| CPM @ 4" stroke | 25 |
| CPM @ 6" stroke | 18 |
| Reservoir Capacity | 20 gallons |
| Input Voltage <i>specify</i> | 230/460 VAC 3PH/60Hz |
| Approximate Foot Print | 32" wide x 43" deep x 49" high |
| Lower 'C' Height | 11.3" |
| Approximate Weight | 1,970 lbs. |

Specifications subject to change without notice.