

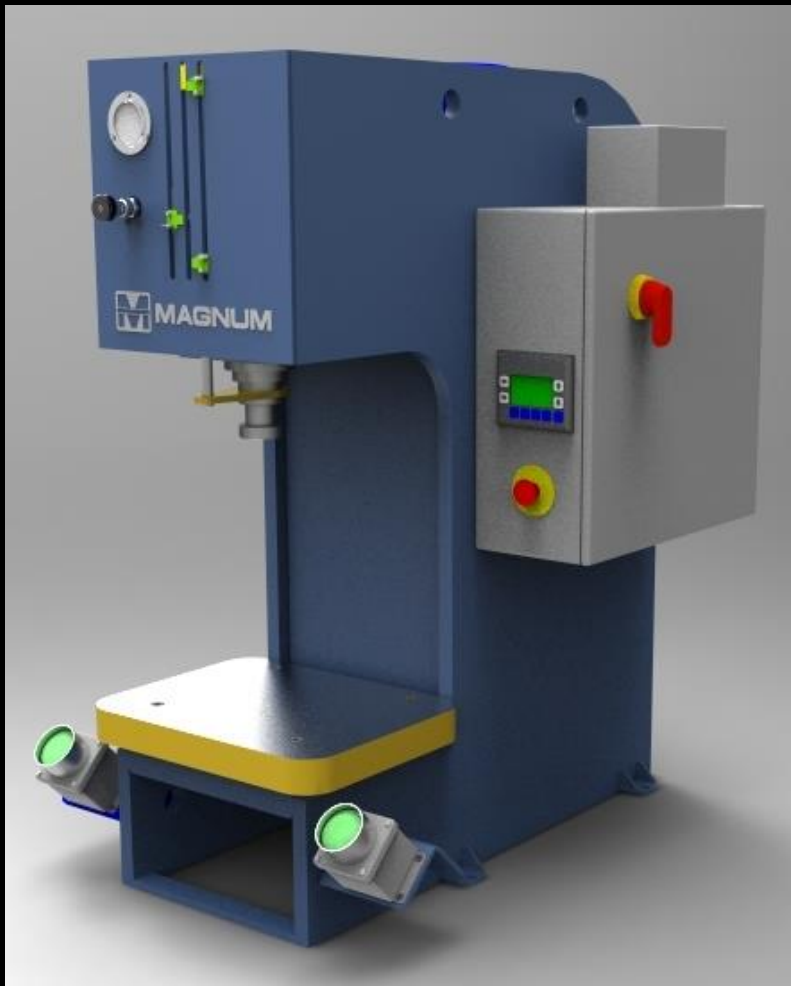

# MAGNUM P R E S S

PO Box 317 - Adamsville, TN 38310 - [www.magnumpress.com](http://www.magnumpress.com) - 731-632-1285 731-632-1283 fax



### Standard Equipment:

- Allen Bradley MicroLogix PLC with Panel View HMI based controls
- 2-Hand No-Tie-Down Start
- CAT 4 Safety Start Relay
- Adjustable Tonnage
- Adjustable Stroke
- Pressure and Distance Reversal Mode
- Manual Setup Mode
- Energy Saver Shut Down
- Top Stop Over-Run
- True 2 Speed Ram
- Electro-Hydraulic Decompression
- Self-Contained Removable Hydraulic Power Unit
- Visual Level/Temp Gauge
- Removable Bolster
- Lockable Disconnect
- NEMA enclosures
- TEFC EISA Compliant Electric Motor
- Magnetic Starter/ Electronic Overload
- Single Point Power Connection

*Magnum Press has a long list of options that you can select from to customize your press the way you need it.*

## MCB10B 10 Ton High Speed Bench Model Gap Frame Press

### Bench Model Gap Frame Hydraulic Press

Often referred to as a "C" frame hydraulic press, these compact hydraulic presses are available in standard model configurations from 2 ton to 35 tons. These machines can be easily customized for your application. They are designed to be mounted on separate stand or table. These self contained hydraulic presses are suitable for a wide variety of operations including assembly, blanking, coining, forming, punching, riveting and staking. As with any Magnum hydraulic press they can be modified to meet your specific need. They are available in MCB standard gap frame configuration, M2PB 2 post guided tool plate, M4PB 4 post guided tool plate, MGB gib guided and an MCC economical compact version.

### Optional FS-02 Bench



30" High



# MAGNUM PRESS

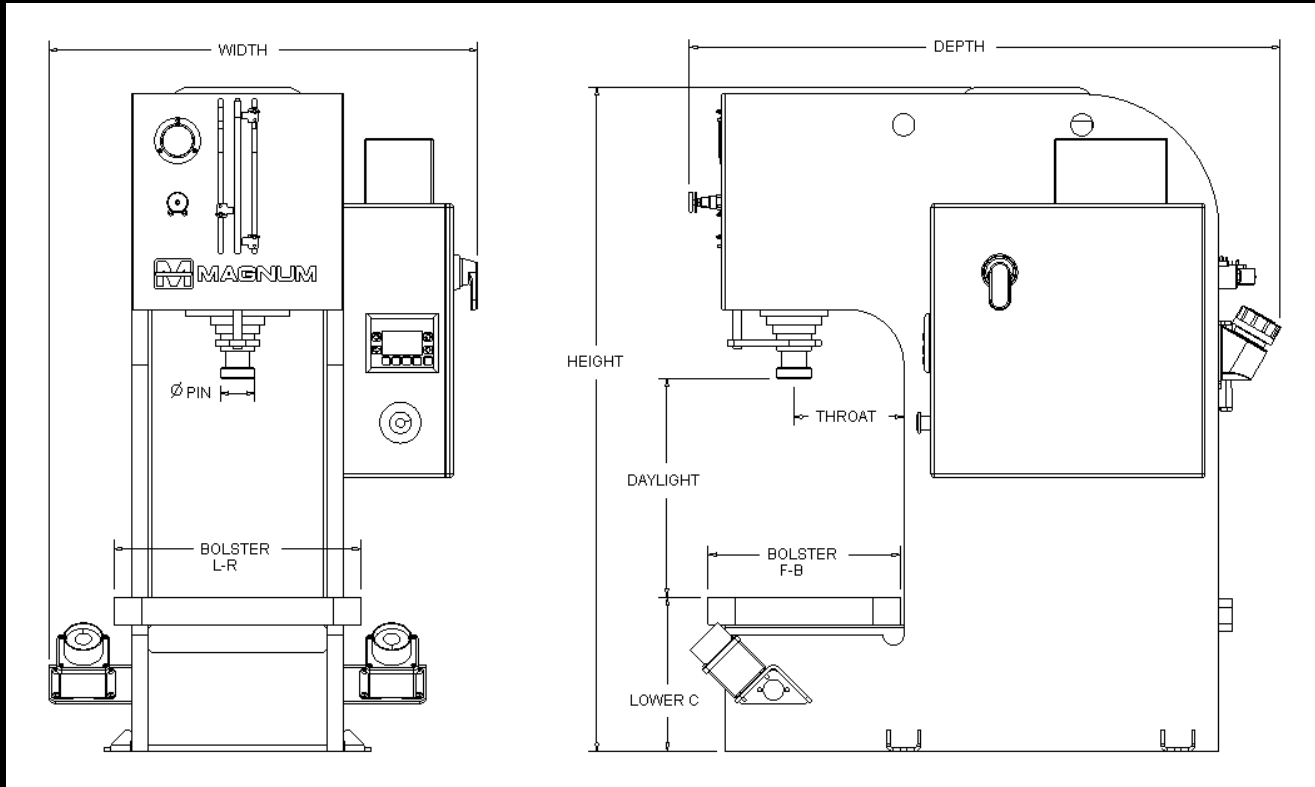

MODEL NUMBER	MCB10B High Speed 10 Ton Gap Frame Press
Adjustable Tonnage (rated)	2.1 tons to 10.4 tons
Daylight	16"
Shut Height	8"
Throat	8"
Bolster Left to Right	18"
Bolster Front to Back	14"
Stroke Length <i>adjustable</i>	1" to 8"
Cycles per Min based on listed total stroke and 0.13" work stroke	
CPM @ 1" stroke	78
CPM @ 2" stroke	93
CPM @ 3" stroke	78
CPM @ 4" stroke	67
CPM @ 6" stroke	52
Reservoir Capacity	20 gallons
Input Voltage <i>specify</i>	230/460 VAC 3PH/60Hz
Approximate Foot Print	32" wide x 43" deep x 49" high
Lower 'C' Height	11.3"
Approximate Weight	1,800 lbs.

Specifications subject to change without notice.