



# MAGNUM PRESS

PO Box 317 - 725 E. Main St. - Adamsville, TN 38310 - [www.magnumpress.com](http://www.magnumpress.com) - 731-632-1285



### Standard Equipment:

- Allen Bradley MicroLogix PLC with Panel View HMI based controls
- NFPA79 & UL508A Compliant Electrical Controls
- 2-Hand No-Tie-Down Start
- CAT 4 Safety Start Relay
- Adjustable Tonnage
- Adjustable Stroke
- Pressure and Distance Reversal Mode
- Manual Setup Mode
- Energy Saver Shut Down
- Top Stop Over-Run
- True 2 Speed Ram
- Electro-Hydraulic Decompression
- Self-Contained Removable Hydraulic Power Unit
- Visual Level/Temp Gauge
- Removable Bolster
- Lockable Disconnect
- NEMA enclosures
- TEFC EISA Compliant Electric Motor
- Magnetic Starter/ Electronic Overload
- Single Point Power Connection

*Magnum Press has a long list of options that you can select from to customize your press the way you need it.*

## MGF Series Floor Model 4 - 35 Ton Gap Frame Press with Heavy Duty GIB Guided Tool Plate

### Floor Model Gap Frame Hydraulic Press

Often referred to as a "C" frame hydraulic press, these hydraulic presses are available in standard model configurations from 10 to 250 tons. Our floor model presses require no separate stand and they have larger bed areas than the equivalent tonnage size bench model hydraulic press. They may have increased cycle rates and can be easily customized for your application. Our GIB guided gap frame hydraulic presses provide the Ultimate in tooling guidance for your really HEAVY DUTY off-center-loading applications. These models feature "off-the-shelf", self lubricating and replaceable bronze gib material making them better suited to handle tougher jobs. All of our GIB Guided presses feature 6 point bearing contact with adjustment bolts to compensate for wear. In some cases the GIB guided tool plates can totally eliminate the need for a die set altogether. These self contained hydraulic presses are suitable for a wide variety of operations including assembly, blanking, coining, forming, punching, riveting and staking. 2-Post and 4-Post designs are also available if you need tooling guidance without the extreme service that GIB guiding can offer. Magnum's rigidly guided RAM designs are all equipped with oversized ram guide bushings for superior guidance and resistance to deflection in moderately off-center-loaded applications. Standard features include completely removable power packs, robust fabricated steel frames and fast, reliable hydraulic systems.



# MAGNUM PRESS

PO Box 317 - 725 E. Main St. - Adamsville, TN 38310 - [www.magnumpress.com](http://www.magnumpress.com) - 731-632-1285

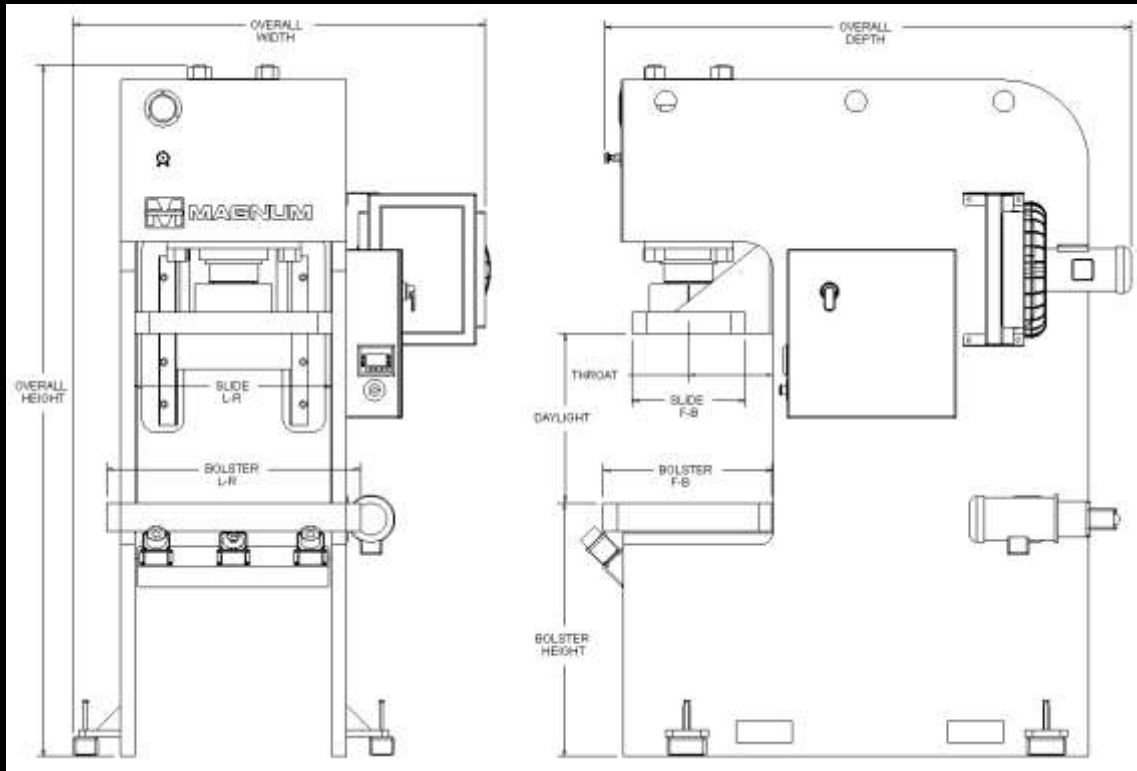

MODEL	MGF-	4A	4B	6A	6B	10A	10B	15A	15B	25A	25B	35A	35B
Rated Tonnage (Adjustable)		3.9	3.9	6.1	6.1	10.4	10.4	15.7	15.7	24.5	24.5	35.3	35.3
STANDARD Inches Per Minute (IPM)	RAPID	420	635	390	1300	400	1200	305	1030	265	820	275	790
	WORK	200	300	190	190	150	150	120	120	130	130	125	125
	RETURN	380	570	375	1250	240	750	200	660	255	790	225	630
CPM (1")	.13" WORK	90	90	78	78	68	68	70	70	70	70	70	70
CPM (4")		37	80	31	67	25	61	27	61	26	56	26	56
Stroke (in. adjustable)		8	8	8	8	10	10	10	10	12	12	12	12
Daylight (in)		16	16	16	16	20	20	20	20	24	24	24	24
Shut Height (in)		8	8	8	8	10	10	10	10	12	12	12	12
Throat (in)		8	8	8	8	10	10	10	10	12	12	12	12
Bolster L-R (in)		14	14	15	15	17	17	20	20	22	22	24	24
Bolster F-B (in)		12	12	13	13	16	16	16	16	19	19	20	20
Slide L-R (in)		11.5	11.5	13	13	15	15	17	17	19	19	21	21
Slide F-B (in)		7	7	8	8	9	9	10	10	12	12	13	13
Width (in)		30	30	31	31	32	32	34	34	36	36	38	38
Depth (in)		42	42	42	42	48	48	56	56	64	64	65	65
Height (in)		71	71	72	72	80	80	81	81	91	91	94	94
Approx Weight (lbs)		1225	1255	1540	1613	2297	2373	3345	3456	4656	4762	5792	6022
Bolster Height (in)		36	36	36	36	36	36	36	36	36	36	36	36

Specifications subject to change without notice.