

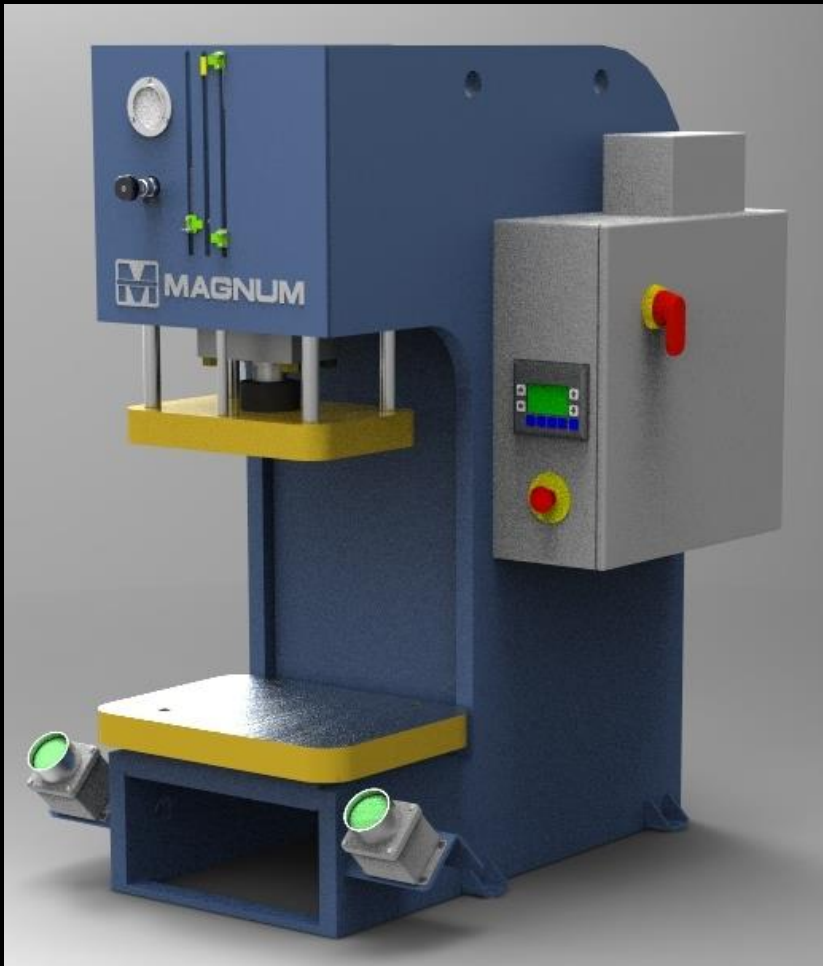

# MAGNUM P R E S S

PO Box 317 - Adamsville, TN 38310 - [www.magnumpress.com](http://www.magnumpress.com) - 731-632-1285 731-632-1283 fax



#### Standard Equipment:

- Allen Bradley MicroLogix PLC with Panel View HMI based controls
- NFPA79 & UL508A Compliant Electrical Controls
- 2-Hand No-Tie-Down Start
- CAT 4 Safety Start Relay
- Adjustable Tonnage
- Adjustable Stroke
- Pressure and Distance Reversal Mode
- Manual Setup Mode
- Energy Saver Shut Down
- Top Stop Over-Run
- True 2 Speed Ram
- Electro-Hydraulic Decompression
- Self-Contained Removable Hydraulic Power Unit
- Visual Level/Temp Gauge
- Removable Bolster
- Lockable Disconnect
- NEMA enclosures
- TEFC EISA Compliant Electric Motor
- Magnetic Starter/ Electronic Overload
- Single Point Power Connection

*Magnum Press has a long list of options that you can select from to customize your press the way you need it.*

## M4PB Series Bench Model Gap Frame Press with 4 Post Guided Tool Plate

#### Bench Model Gap Frame Hydraulic Press

Often referred to as a "C" frame hydraulic press, these compact hydraulic presses are available in standard model configurations from 2 ton to 35 tons. These machines can be easily customized for your application. They are designed to be mounted on separate stand or table. These self contained hydraulic presses are suitable for a wide variety of operations including assembly, blanking, coining, forming, punching, riveting and staking. As with any Magnum hydraulic press they can be modified to meet your specific need. They are available in MCB standard gap frame configuration, M2PB 2 post guided tool plate, M4PB 4 post guided tool plate, MGB gib guided and an MCC economical compact version.

#### Optional Floor Stands:

- FS-01 fits 2-6 Ton Presses  
24" wide x 30" deep x 30" high
- FS-02 fits 10-15 Ton Presses  
30" wide x 40" deep x 30" high
- FS-03 fits 25-35 Ton Presses  
32" wide x 45" deep x 20" high



# MAGNUM P R E S S

PO Box 317 - Adamsville, TN 38310 - [www.magnumpress.com](http://www.magnumpress.com) - 731-632-1285 731-632-1283 fax

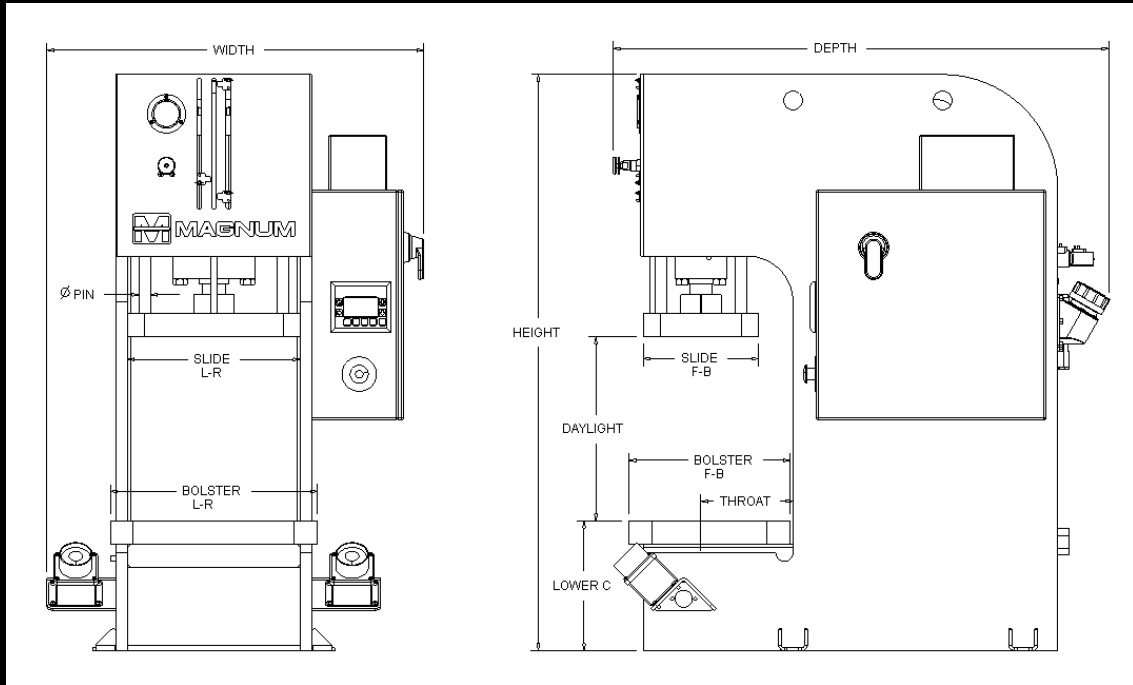

MODEL	M4PB-	4A	4B	6A	6B	10A	10B	15A	15B	25A	25B	35A	35B
Rated Tonnage (Adjustable)		3.9	3.9	6.1	6.1	10.4	10.4	15.7	15.7	24.5	24.5	35.3	35.3
Minimum Tonnage		0.8	0.8	1.2	1.2	2.1	2.1	3.1	3.1	4.9	4.9	7.1	7.1
STANDARD Inches Per Minute (IPM)	RAPID	420	635	390	1300	400	1200	305	1030	265	820	275	790
	WORK	200	300	190	190	150	150	120	120	130	130	125	125
	RETURN	380	570	375	1250	240	750	200	660	255	790	225	630
CPM (1")	.13"	90	110	90	90	78	78	68	68	70	70	70	70
CPM (4")	WORK	40	52	37	80	31	67	25	61	27	61	26	56
Stroke (in. adjustable)		7	7	7	7	8	8	8	8	10	10	10	10
Daylight (in)		14	14	14	14	16	16	16	16	20	20	20	20
Shut Height (in)		7	7	7	7	8	8	8	8	10	10	10	10
Throat (in)		7	7	7	7	8	8	8	8	10	10	10	10
Bolster L-R (in)		14	14	14	14	18	18	19	19	24	24	25	25
Bolster F-B (in)		12	12	12	12	14	14	14	14	16	16	17.5	17.5
Slide L-R (in)		12	12	12	12	15	15	15	15	20	20	20	20
Slide F-B (in)		8	8	8	8	10	10	10	10	10.5	10.5	13	13
Slide Pin Dia (in)		1	1	1	1	1	1	1	1	1.5	1.5	1.5	1.5
HP (1800 rpm)		3	5	5	5	7.5	7.5	10	10	15	15	20	20
Reservoir Capacity (gal)		14	14	14	14	25	25	25	25	60	60	60	60
Width (in)		29	29	29	29	33	33	34	34	39	39	39	39
Depth (in)		42	42	42	42	43	43	43	43	55	55	57	57
Height (in)		40	40	40	40	50	50	50	50	60	60	62	62
Approx Weight (lbs)		780	810	840	875	2050	2100	2160	2210	4015	4105	4780	4860
Lower 'C' Height (in)		9	9	9	9	11.3	11.3	11.3	11.3	14	14	14.5	14.5
Bolster Thickness (in)		1.25	1.25	1.25	1.25	2	2	2	2	2.5	2.5	2.5	2.5

Specifications subject to change without notice.